

REVISIONS				
REV	ECN #	DESCRIPTION	REV. BY/DATE	APR. BY
A	-----	INITIAL RELEASE	04/2000	

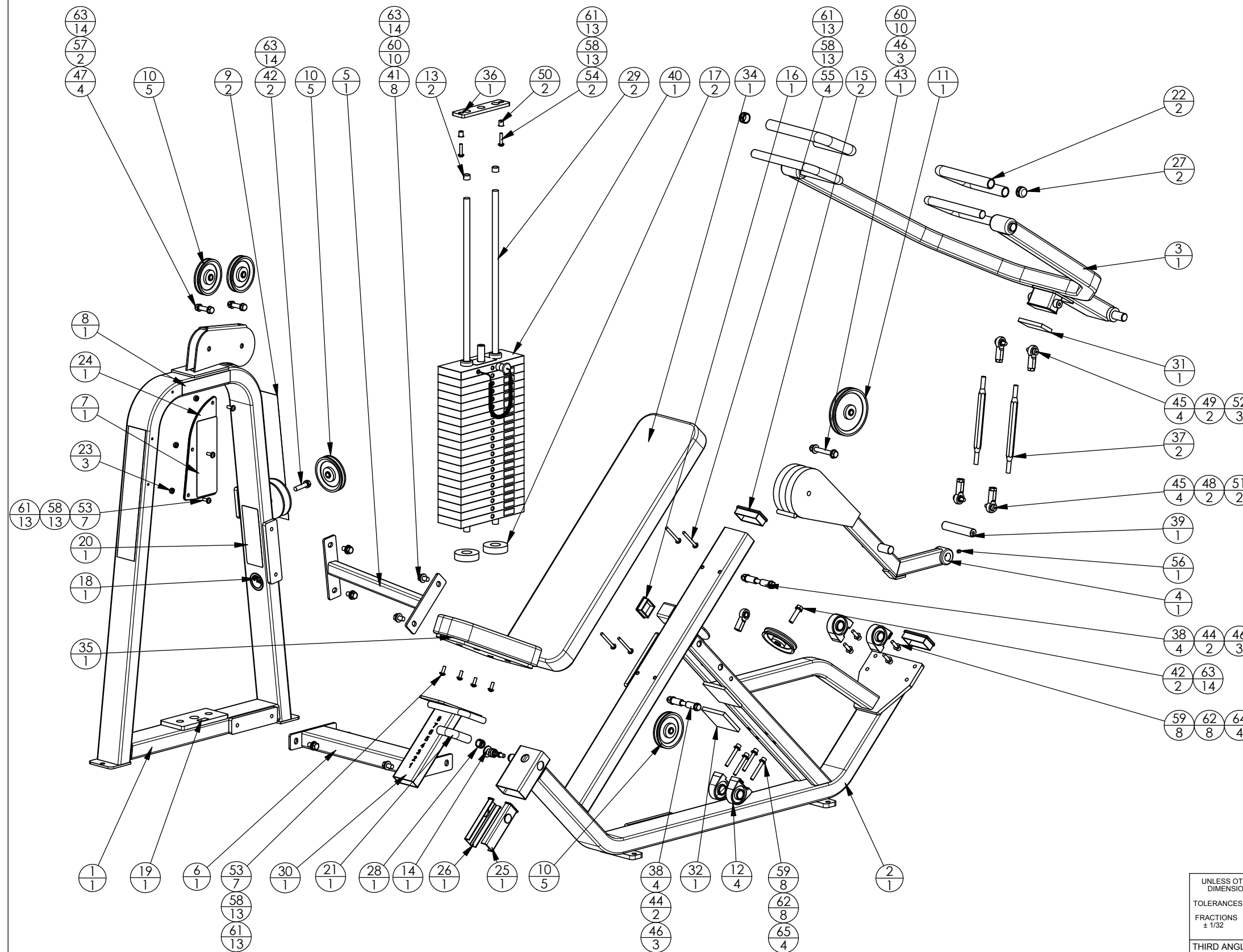

ITEM NO.	QTY.	PART NO.	DESCRIPTION
1	1	500-SA-1	500 MAIN FRAME ASSY
2	1	500-SA-2	500 SEAT FRAME ASSY
3	1	500-SA-3	500 PRESS ARM ASSY
4	1	500-SA-4	500 PIVOTING COUNTERBALANCE ASSY
5	1	500-SA-5	500 UPPER LINK STRUT ASSY
6	1	500-SA-6	500 LOWER LINK STRUT ASSY.
7	1	AC0500B	LABEL, INSTRUCTION, "SHOULDER PRESS 500"
8	1	AC1001	LABEL, "ICARIAN", 1 1/2 x 8 1/8
9	2	AC1002	LABEL, "ICARIAN", 3 1/2 x 21 1/2
10	5	AC1009	PULLEY, 4 1/2" DIA x 1/2" ID
11	1	AC1010	PULLEY, 6" DIA x 1/2" ID
12	4	AC1026	PILLOW BLOCK BEARING 2 BOLT, TAPPED
13	2	AC1040	CAP. GUIDE ROD, DIA. 3/4
14	1	AC1051-MS	SNAP PIN, SMALL M-PULL
15	2	AC1057	CAP. BLACK PLASTIC, 2 x 4
16	1	AC1058	CAP. BLACK PLASTIC, 2 x 2
17	2	AC1148	WEIGHT STACK BUMPER
18	1	AC1161	LABEL, ROUND, "MADE IN USA"
19	1	AC1164	LABEL, F.P.I. SERIAL NUMBER
20	1	AC1183	LABEL, "WARNING, SERIOUS INJURY..."
21	1	AC1225-6	RUBBERGRIP, DIA 3/4 x (5)
22	2	AC1226-21	RUBBERGRIP, DIA 1 x (21)
23	3	AC1228	SPACER, ALU, 21/64 ID x 5/8 OD x (1/4)
24	1	AC1230	INSTRUCTION PLACARD, 1/4" TEXTURED ABS PLASTIC
25	1	AC1236-P	PLASTIC GLIDE WITH PLUG
26	1	AC1236-H	PLASTIC GLIDE WITH HOLE
27	2	AC218	HANDLE END CAP W/SET SCREWS, DIA 1"
28	1	AC220	HANDLE END CAP W/SET SCREWS, DIA 3/4"
29	2	CH1212	GUIDE ROD, 3/4 x 42 5/8 (#4)
30	1	CH4002	ASSY. SEAT ADJ, 20 DEG, 8 HOLE
31	1	CP0008	CUT PIECE CREPE 7/16 x 2 x (4)
32	1	CP1036	CUT PIECE, CREPE, 7/16 x 3 3/4 x 3 3/4
33	1	GP-500-112-125	CABLE ASSY, GP-500-112-125
34	1	PD1102	PAD, 9 x 36, 4 HOLES
35	1	PD1207	PAD, SEAT, 9 x 5 x (14 1/2), 4 HOLES
36	1	PF1016	STEEL BAR FLAT CR/HR, 3/8 x 2 x (8 1/4)
37	2	PF1136	LINK ARM, 11", W/ THREADED ENDS
38	4	PF3186	STEEL BAR RND DIA. 1" x (1 1/2), 1 HOLE
39	1	PF3212	STEEL BAR RND, DIA. 0.995" x (5), 2 HOLES TAPPED
40	1	WS2000	WEIGHT STACK, 20 PLATE, 200 LBS.
41	8	FA1011	BOLT, HEX HEAD, BLK, 1/2-13 x 1
42	2	FA1013	BOLT, HEX HEAD, 1/2-13 x 2
43	1	FA1018	BOLT, HEX HEAD, BLK, 1/2-13 x 4
44	2	FA1020	BOLT, HEX HEAD, BLK, 1/2-13 x 5
45	4	FA1027	BOLT, SHOULDER, 3/8-16 x 1/2 x 5/8
46	3	FA1030	NUT, HEX, NYLOCK, 1/2-13
47	4	FA1035	NUT, HEX, ACORN, 1/2-13
48	2	FA1044	NUT, HEX, THIN, LEFT HAND THREAD, 1/2-20
49	2	FA1046	NUT, HEX, THIN, RIGHT HAND THREAD, 1/2-20
50	2	FA1055	NUT, INSERT, 5/16-18
51	2	FA1063	ROD END, FEMALE, STEEL, ZINC, CAD, L.H.T.
52	3	FA1064	ROD END, FEMALE, STEEL, ZINC, CAD, R.H.T.
53	7	FA1071	BOLT, BUTTON HEAD, 5/16-18 x 1
54	2	FA1072	BOLT, BUTTON HEAD, 5/16-18 x 1 1/2
55	4	FA1074	BOLT, BUTTON HEAD, 5/16-18 x 3
56	1	FA1082	SCREW, SET, SCKT, CUP POINT, 3/8-16 x 3/8
57	2	FA1101	STUD, 1/2-13 x 2 1/2
58	13	FA1106	WASHER, FLAT, 5/16 ID x 11/16 OD
59	8	FA1107	WASHER, FLAT, 3/8 ID x 13/16 OD
60	10	FA1109	WASHER, FLAT, 1/2 ID x 1 1/16 OD
61	13	FA1116	WASHER, SPLIT, 5/16 ID
62	8	FA1117	WASHER, SPLIT, 3/8 ID
63	14	FA1119	WASHER, SPLIT, 1/2 ID
64	4	FA1142	BOLT, SOCKET HEAD, 3/8-16 x 1 1/4
65	4	FA1143	BOLT, SOCKET HEAD, 3/8-16 x 2 3/4

WEIGHT: 525 LBS.

UNLESS OTHERWISE SPECIFIED DIMENSIONS ARE IN INCHES

TOLERANCES ARE:

FRACTIONS	DECIMALS	ANGLES
± 1/32	.XX ± .01	± 1°
	.XXX ± .005	

THIRD ANGLE PROJECTION

DO NOT SCALE DRAWING

FITNESS PRODUCTS INTERNATIONAL
ICARIAN FITNESS PRODUCTS INTERNATIONAL
 ICARIAN FLITE ABENCH JADE STRETCH CENTER
 12660 BRANFORD ST. SUN VALLEY, CA. 91352

APPROVALS	DATE	TITLE	SCALE
DESIGNED BY RSG	01/00	SHOULDER PRESS	1:13
MODELED BY RSG	01/00		SHEET 1 OF 1
DRAWN BY RJB	04/00	SIZE B	REV A
APPROVED BY		DWG. NO. 500-EXP	

500 Shoulder Press

Part Number	Description	Bubble Number
CW500SA1-211	ASSY,FRAME,MAIN,500,SKY WHITE	1.01
CW500SA1-221	ASSY,FRAME,MAIN,500,BLACK	1.02
CW500SA1-231	ASSY,FRAME,MAIN,500,RED	1.03
CW500SA1-241	ASSY,FRAME,MAIN,500,PLAT SPRKLE	1.04
CW500SA1-251	ASSY,FRAME,MAIN,500,SILVER	1.05
CW500SA1-261	ASSY,FRAME,MAIN,500,BLUE	1.06
CW500SA1-271	ASSY,FRAME,MAIN,500,CHARCOAL	1.07
CW500SA1-281	ASSY,FRAME,MAIN,500,CATH GRAY	1.08
CW500SA1-291	ASSY,FRAME,MAIN,500,SILVER VIEN	1.09
CW500SA1-311	ASSY,FRAME,MAIN,500,STONE HG	1.11
CW500SA1-321	ASSY,FRAME,MAIN,500,TITANIUM HG	1.12
CW500SA1-331	ASSY,FRAME,MAIN,500,WHITE GLOSS	1.13
CW500SA1-341	ASSY,FRAME,MAIN,500,BLACK ONYX	1.14
CW500SA1-351	ASSY,FRAME,MAIN,500,LT. BRONZE	1.15
CW500SA1-361	ASSY,FRAME,MAIN,500,SAPPHIRE BL	1.16
CW500SA2-211	ASSY,SEAT FRAME,500,SKY WHITE	2.01
CW500SA2-212	ASSY,SEAT FRAME,500,SKY WHITE	2.01
CW500SA2-221	ASSY,SEAT FRAME,500,BLACK	2.02
CW500SA2-222	ASSY,SEAT FRAME,500,BLACK	2.02
CW500SA2-231	ASSY,SEAT FRAME,500,RED	2.03
CW500SA2-241	ASSY,SEAT FRAME,500,PLATINUM SPRKL	2.04
CW500SA2-251	ASSY,SEAT FRAME,500,LIGHT BRONZE	2.05
CW500SA2-261	ASSY,SEAT FRAME,500,BLUE	2.06
CW500SA2-271	ASSY,SEAT FRAME,500,CHARCOAL	2.07
CW500SA2-281	ASSY,SEAT FRAME,500,CATHEDRAL GREY	2.08
CW500SA2-291	ASSY,SEAT FRAME,500,SILVER VIEN	2.09
CW500SA2-311	ASSY,SEAT FRAME,500,STONE HG	2.11
CW500SA2-312	ASSY,SEAT FRAME,500,STONE HG	2.11
CW500SA2-321	ASSY,SEAT FRAME,500,TITANIUM HG	2.12
CW500SA2-322	ASSY,SEAT FRAME,500,TITANIUM HG	2.12
CW500SA2-331	ASSY,SEAT FRAME,500,WHITE GLOSS	2.13
CW500SA2-341	ASSY,SEAT FRAME,500,BLACK ONYX	2.14
CW500SA2-351	ASSY,SEAT FRAME,500,LIGHT BRONZE	2.15
CW500SA2-352	ASSY,SEAT FRAME,500,LIGHT BRONZE	2.15
CW500SA2-361	ASSY,SEAT FRAME,500,SAPPHIRE BLUE	2.16
CW500SA2-362	ASSY,SEAT FRAME,500,SAPPHIRE BLUE	2.16
CW500SA3-211	ASSY,PRESS ARM,500,SKY WHITE	3.01
CW500SA3-221	ASSY,PRESS ARM,500,BLACK	3.02
CW500SA3-231	ASSY,PRESS ARM,500,RED	3.03
CW500SA3-241	ASSY,PRESS ARM,500,PLAT SPKLE	3.04
CW500SA3-251	ASSY,PRESS ARM,500,SILVER	3.05
CW500SA3-261	ASSY,PRESS ARM,500,BLUE	3.06
CW500SA3-271	ASSY,PRESS ARM,500,CHARCOAL	3.07
CW500SA3-281	ASSY,PRESS ARM,500,CATH GRY	3.08
CW500SA3-291	ASSY,PRESS ARM,500,SILVER VIEN	3.09
CW500SA3-311	ASSY,PRESS ARM,500,STONE HG	3.11
CW500SA3-321	ASSY,PRESS ARM,500,TITANIUM HG	3.12
CW500SA3-331	ASSY,PRESS ARM,500,WHITE GLOSS	3.13
CW500SA3-341	ASSY,PRESS ARM,500,BLACK ONYX	3.14

CW500SA3-351	ASSY,PRESS ARM,500,LIGHT BRONZE	3.15
CW500SA3-361	ASSY,PRESS ARM,500,SAPPHIRE BLUE	3.16
CW500SA4-721	ASSY, 500 PIVOTING COUNTERBALAN	4
CW500SA5-211	ASSY,UPPER LINK STRUT,500,SKY WHITE	5.01
CW500SA5-221	ASSY,UPPER LINK STRUT,500,BLACK	5.02
CW500SA5-231	ASSY,UPPER LINK STRUT,500,RED	5.03
CW500SA5-241	ASSY,UPPER LINK STRUT,500,PLATINUM	5.04
CW500SA5-251	ASSY,UPPER LINK STRUT,500,SILVER	5.05
CW500SA5-261	ASSY,UPPER LINK STRUT,500,BLUE	5.06
CW500SA5-271	ASSY,UPPER LINK STRUT,500,CHARCOAL	5.07
CW500SA5-281	ASSY,UPPER LINK STRUT,500,CATHEDRAL	5.08
CW500SA5-291	ASSY,UPPER LINK STRUT,500,SILVER VI	5.09
CW500SA5-311	ASSY,UPPER LINK STRUT,500,STONG HG	5.11
CW500SA5-321	ASSY,UPPER LINK STRUT,500,TITANIUM	5.12
CW500SA5-331	ASSY,UPPER LINK STRUT,500,WHITE GLO	5.13
CW500SA5-341	ASSY,UPPER LINK STRUT,500,BLACK ONY	5.14
CW500SA5-351	ASSY,UPPER LINK STRUT,500,LIGHT BRO	5.15
CW500SA5-361	ASSY,UPPER LINK STRUT,500,SAPPHIRE	5.16
CW500SA6-211	ASSY,LOWER LINK STRUT,500,SKY WHITE	6.01
CW500SA6-221	ASSY,LOWER LINK STRUT,500,BLACK	6.02
CW500SA6-231	ASSY,LOWER LINK STRUT,500,RED	6.03
CW500SA6-241	ASSY,LOWER LINK STRUT,500,PLATINUM	6.04
CW500SA6-251	ASSY,LOWER LINK STRUT,500,SILVER	6.05
CW500SA6-261	ASSY,LOWER LINK STRUT,500,BLUE	6.06
CW500SA6-271	ASSY,LOWER LINK STRUT,500,CHARCOAL	6.07
CW500SA6-281	ASSY,LOWER LINK STRUT,500,CATHEDRAL	6.08
CW500SA6-291	ASSY,LOWER LINK STRUT,500,SILVER VI	6.09
CW500SA6-311	ASSY,LOWER LINK STRUT,500,STONE HG	6.11
CW500SA6-321	ASSY,LOWER LINK STRUT,500,TITANIUM	6.12
CW500SA6-331	ASSY,LOWER LINK STRUT,500,WHITE GLO	6.13
CW500SA6-341	ASSY,LOWER LINK STRUT,500,BLACK ONY	6.14
CW500SA6-351	ASSY,LOWER LINK STRUT,500,LIGHT BRO	6.15
CW500SA6-361	ASSY,LOWER LINK STRUT,500,SAPPHIRE	6.16
CWAC1009-101	PULLEY, 4 1/2 DIA. X 1/2 ID	10
CWAC1010-101	PULLEY, 6 DIA X 1/2 ID	11
CW12406-101	PILLOW BLOCK, BEARING, 2 BOLT	12
CW12404-101	CAP, GUIDE ROD,DIA 3/4, BLK	13
CW30165-751	ASSY, POP PIN, 0.450 DIA HANDLE, B	14
CW32460-321	ASSY, RATCHETING LEVER, TITANIUM	14
CW11311-102	ENDCAP, REC TUBE, 2X4, BLK PLASTIC	15
CW11311-103	ENDCAP, REC TUBE, 2X2, BLK PLASTIC	16
CW12402-101	BUMPER, WEIGHT STACK, BLK RUBBER	17
CWGR2621-000	GRIP,RUBBER, 1" DIA, 21"	22
CWAC1228-901	SPACER, ALU,.328 ID X .625 OD X .25	23
CWAC1236-101	GUIDE INSERT, PLASTIC WITHOUT HOLE,	25
CWAC1236-102	GUIDE INSERT, PLASTIC WITH HOLE, BL	26
CWAC218-901	HANDLE END CAP W/SET SCREWS, DIA 1"	27
CWPF1212-711	GUIDE ROD, 3/4 X 42 5/8 (#4), CHM	29
CW30288-711	ASSY,SEAT ADJUST,20 DEGREE, 8 HOLE,	30
CW32212-711	ASSEMBLY, SEATPAD ADJUSTMENT, 8 HO	30
CW30014-105	CUT PIECE, CREPE, 7/16 X 2 X 4	31

CW30014-113	CUT PIECE, CREPE, 7/16 X 3 3/4 X 3	32
CWCLGP112-125	ASSY, CABLE, 500	33
CWPD1102J-101	PAD,FLAT,10X36,4HOLES,W/BP,BLACK,W/	34.01
CWPD1102J-102	PAD,FLAT,10X36,4HOLES,W/BP,RYL BL,W	34.02
CWPD1102J-103	PAD,FLAT,10X36,4HOLES,W/BP,DVE GRY,	34.03
CWPD1102J-104	PAD,FLAT,10X36,4HOLES,W/BP,CROCUS,W	34.04
CWPD1102J-105	PAD,FLAT,10X36,4HOLES,W/BP,GROTTO,W	34.05
CWPD1102J-106	PAD,FLAT,10X36,4HOLES,W/BP,GRAPHITE	34.06
CWPD1102J-107	PAD,FLAT,10X36,4HOLES,W/BP,RED,W/SL	34.07
CWPD1102J-108	PAD,FLAT,10X36,4HOLES,W/BP,CHN GRN,	34.08
CWPD1102J-109	PAD,FLAT,10X36,4HOLES,W/BP,TURQSE,W	34.09
CWPD1102J-110	PAD,FLAT,10X36,4HOLES,W/BP,RASP,W/S	34.1
CWPD1102J-111	PAD,FLAT,10X36,4HOLES,W/BP,PLUM,W/S	34.11
CWPD1102J-112	PAD,FLAT,10X36,4HOLES,W/BP,REGIMENT	34.12
CWPD1102J-113	PAD,FLAT,10X36,4HOLES,W/BP,SPC BLUE	34.13
CWPD1102J-115	PAD,FLAT,10X36,4HOLES,W/BP,BLK LTHR	34.15
CWPD1102J-116	PAD,FLAT,10X36,4HOLES,W/BP,NVBL LTH	34.16
CWPD1102J-117	PAD,FLAT,10X36,4HOLES,W/BP,PUTTY,W/	34.17
CWPD1102J-118	PAD,FLAT,10X36,4HOLES,W/BP,IMPRL BL	34.18
CWPD1102J-119	PAD,FLAT,10X36,4HOLES,W/BP,YEW GRN,	34.19
CWPD1102J-120	PAD,FLAT,10X36,4HOLES,W/BP,DSTY JDE	34.2
CWPD1102J-121	PAD,FLAT,10X36,4HLS,W/BP,TRRA CTTA,	34.21
CWPD1102J-122	PAD,FLAT,10X36,4HOLES,W/BP,PAPRIKA,	34.22
CWPD1102J-123	PAD,FLAT,10X36,4HLS,W/BP,ASH LTHR,W	34.23
CWPD1102J-124	PAD,FLAT,10X36,4HL,W/BP,CERULN LTH,	34.24
CWPD1102J-125	PAD,FLAT,10X36,4HL,W/BP,CHARCL LTH,	34.25
CWPD1102J-126	PAD,FLAT,10X36,4HLS,W/BP,HUNTER LTH	34.26
CWPD1102J-127	PAD,FLAT,10X36,4HLS,W/BP,MOSS LTH,W	34.27
CWPD1102J-128	PAD,FLAT,10X36,4HLS,W/BP,SPICE LTH,	34.28
CWPD1102J-129	PAD,FLAT,10X36,4HLS,W/BP,TOMATO LTH	34.29
CWPD1207B-101	PAD,5X9X14.5,4HOLES,W/BP,BLACK	35.01
CWPD1207B-102	PAD,5X9X14.5,4HOLES,W/BP,RYL BL	35.02
CWPD1207B-103	PAD,5X9X14.5,4HOLES,W/BP,DVE GRY	35.03
CWPD1207B-104	PAD,5X9X14.5,4HOLES,W/BP,CROCUS	35.04
CWPD1207B-105	PAD,5X9X14.5,4HOLES,W/BP,GROTTO	35.05
CWPD1207B-106	PAD,5X9X14.5,4HOLES,W/BP,GRAPHITE	35.06
CWPD1207B-107	PAD,5X9X14.5,4HOLES,W/BP,RED	35.07
CWPD1207B-108	PAD,5X9X14.5,4HOLES,W/BP,CHN GRN	35.08
CWPD1207B-109	PAD,5X9X14.5,4HOLES,W/BP,TURQSE	35.09
CWPD1207B-110	PAD,5X9X14.5,4HOLES,W/BP,RASP	35.1
CWPD1207B-111	PAD,5X9X14.5,4HOLES,W/BP,PLUM	35.11
CWPD1207B-112	PAD,5X9X14.5,4HOLES,W/BP,REGIMENT	35.12
CWPD1207B-113	PAD,5X9X14.5,4HOLES,W/BP,SPC BLUE	35.13
CWPD1207B-115	PAD,5X9X14.5,4HOLES,W/BP,BLK LTHR	35.15
CWPD1207B-116	PAD,5X9X14.5,4HOLES,W/BP,NVBL LTH	35.16
CWPD1207B-117	PAD,5X9X14.5,4HOLES,W/BP,PUTTY	35.17
CWPD1207B-118	PAD,5X9X14.5,4HOLES,W/BP,IMPRL BL	35.18
CWPD1207B-119	PAD,5X9X14.5,4HOLES,W/BP,YEW GRN	35.19
CWPD1207B-120	PAD,5X9X14.5,4HOLES,W/BP,DSTY JD	35.2
CWPD1207B-121	PAD,5X9X14.5,4HOLES,W/BP,TER COT	35.21
CWPD1207B-122	PAD,5X9X14.5,4HOLES,W/BP,PAPRIKA	35.22

CWPD1207B-123	PAD,5X9X14.5,4HLS,W/BP,ASH LTHR	35.23
CWPD1207B-124	PAD,5X9X14.5,4HLS,W/BP,CERULAN LTHR	35.24
CWPD1207B-125	PAD,5X9X14.5,4HLS,W/BP,CHARCOAL LTH	35.25
CWPD1207B-126	PAD,5X9X14.5,4HLS,W/BP,HUNTER LTHR	35.26
CWPD1207B-127	PAD,5X9X14.5,4HLS,W/BP,MOSS LTHR	35.27
CWPD1207B-128	PAD,5X9X14.5,4HLS,W/BP,SPICE LTHR	35.28
CWPD1207B-129	PAD,5X9X14.5,4HLS,W/BP,TOMATO LTH	35.29
CWPF1016-731	BAR,,FLAT CR/HR, 3/8 X 2 X 8 1/4, 3	36
CWPF1136-731	LINK ARM, 11", W/ THRD ENDS, 712, B	37
CWPF3186-741	BAR,STEEL, RND, DIA. 1" X (1 1/2),	38
CWPF3212-731	BAR,STEEL, RND, DIA. 0.995" X (5),	39
CW30103-200	WEIGHT STACK,200 LBS,MTP-S,19 X 10	40
CWHCYN050-100	SCREW,HEX HEAD,BLK XYLAN,1/2-13 X 1	41
CWHCYN050-200	SCREW, HEX HEAD, BLK XYLAN, 1/2-13	42
CWHCYN050-400	SCREW, HEX HEAD, BLK XYLAN, 1/2-13	43
CWHCYN050-500	SCREW, HEX HEAD, BLK XYLAN, 1/2-13	44
CWRANN038-063	BOLT, SHOULDER, 3/8-16 X 1/2 X 5/8	45
CWKDYN050-059	LOCKNUT, NYLON INSERT, FULL, UNC, 1	46
CWKADLN050-081	NUT, ACORN, 1/2-13	47
CWKBEYN050-031	NUT, HEX, THIN, LEFT HAND THREAD,	48
CWKRYN050-031	NUT, HEX THIN, UNF, 1/2-20, BLK XYL	49
CW12537-109	NUT,INSERT,THIN-NUT,LARGE FLANGE	50
CWCLFA1063-741	ROD END, FEMALE, STEEL, ZINC, CAD,	51
CWCLFA1064-741	ROD END, FEMALE, STEEL, ZINC, CAD,	52
CWTAYN031-100	SCREW, BUTTON HEAD, BLK XYLAN, 5/1	53
CWTAYN031-150	SCREW, BUTTON HEAD, BLK XYLAN,5/16	54
CWTAYN031-300	SCREW, BUTTON HEAD, BLK XYLAN,5/16	55
CWEANN038-038	SCREW,SET,SCKT,CUP POINT,3/8-16X3/8	56
CWBFNN050-250	STUD, 1/2-13 X 2 1/2	57
CWWBKN031-007	WASHER, FLAT, TYPE A, SAE, 5/16 ID	58
CWWBKN038-007	WASHER, FLAT, TYPE A, SAE, 3/8 ID	59
CWWBKN050-010	WASHER, FLAT, TYPE A, SAE, 1/2 ID X	60
CWWALYN031-008	WASHER, SPLIT, 5/16 ID, BL	61
CWWALYN038-009	WASHER, SPLIT, 3/8 ID, BLK XYLAN	62
CWWALYN050-013	WASHER, SPLIT, 1/2 ID, BLK XYLAN	63
CWCAYN038-125	SCREW, SOCKET HEAD, BLK X	64
CWCAYN038-275	SCREW, SOCKET HEAD, BLK XYLAN, 3/	65
CW30010-101	LABEL,WARNING STRENGTH	66
CW30145-101	ASSY, LABEL,INSTRUCTION,500	67
CW31756-101	LABEL, PRECOR USA ICARIAN LINE	68
CWPF4002-711	WELDMENT, SEAT ADJUST, 20 DEGREE, 8	70
CWAC220-901	HANDLE END CAP W/SET SCREWS, DIA 3/	71
CW12634-101	SPRING, TORSION 90 DEG X 0.484 X 0.	72
CWGR2505-000	GRIP,RUBBER,3/4" DIA, 5"	72
CW31770-742	LATCH PIVOTING PIN, CLR ZN	73
CW31784-731	STOP PLUG, BLK ZN	73
CWAMNN028-003	RING, RETAINING, 2-TURN, SPIRAL, SS	74
CW12633-101	ENDCAP, REC TUBE, LDP, 1 1/2 X 3 1	75
CW10510-721	ASSY, PLATE, WEIGHT, 10 LBS, WRKL B	201
CW10520-721	ASSY, PLATE, WEIGHT, 20 LBS, WRKL B	202
CWAC1133-101	BUSHING, WEIGHT PLATE, LDPE PLASTIC	203

CW30172-751	ASSY, 4.00 IN WEIGHT STACK PIN AND	227
CW30173-751	ASSY, 6.00 IN WEIGHT STACK PIN AND	228
CWLDNN038-200	PIN, ROLL, DIA 3/8 X 2	250
CW30184-901	ASSY,BARREL, TOP PLATE,ALUMINUM	251
CW10550-722	PLATE, WEIGHT, MED TOP (MTP-S), 10	283
CW30132-711	SELECTOR STEM, 20 PLATE,0 .875 DIA,	308
CW30011-101	LABEL,WARNING WEIGHT STACK	311
CW12401-106	LABEL, WEIGHT PLATE, 20 LBS/ 8 KG	319
CW12401-110	LABEL, WEIGHT PLATE, 30 LBS/ 13.6 K	323
CW12401-114	LABEL, WEIGHT PLATE, 40 LBS/ 18.2 K	327
CW12401-118	LABEL, WEIGHT PLATE, 50 LBS/ 22.7 K	331
CW12401-120	LABEL, WEIGHT PLATE, 60 LBS/ 27.3 K	333
CW12401-122	LABEL, WEIGHT PLATE, 70 LBS/ 31.8 K	335
CW12401-124	LABEL, WEIGHT PLATE, 80 LBS/ 36.4 K	337
CW12401-126	LABEL, WEIGHT PLATE, 90 LBS/ 40.9 K	339
CW12401-128	LABEL, WEIGHT PLATE, 100 LBS/ 45.5	341
CW12401-129	LABEL, WEIGHT PLATE, 110 LBS/ 50 KG	342
CW12401-130	LABEL, WEIGHT PLATE, 120 LBS/ 54.6	343
CW12401-131	LABEL, WEIGHT PLATE, 130 LBS/ 59.1	344
CW12401-132	LABEL, WEIGHT PLATE, 140 LBS/ 63.6	345
CW12401-133	LABEL, WEIGHT PLATE, 150 LBS/ 68.2	346
CW12401-134	LABEL, WEIGHT PLATE, 160 LBS/ 72.7	347
CW12401-135	LABEL, WEIGHT PLATE, 170 LBS/ 77.3	348
CW12401-136	LABEL, WEIGHT PLATE, 180 LBS/ 81.8	349
CW12401-137	LABEL, WEIGHT PLATE, 190 LBS/ 86.4	350
CW12401-138	LABEL, WEIGHT PLATE, 200 LBS/ 90.9	351
CW12401-139	LABEL, WEIGHT PLATE, 210 LBS/ 95.5	352
CW12401-141	LABEL, WEIGHT PLATE, 230 LBS/ 104.6	354
CW12401-143	LABEL, WEIGHT PLATE, 250 LBS/ 113.6	356
CW12537-109	NUT,INSERT,THIN-NUT,LARGE FLANGE	400
CW30126-101	LABEL,VINYL, PRECOR, 3.25 X 18.0	401
CWPF3143-211	SHROUD,SHEET,STEEL,3/32 THICK,4 BEN	402.01
CWPF3143-221	SHROUD,SHEET,STEEL,3/32 THICK,4 BEN	402.02
CWPF3143-231	SHROUD,SHEET,STEEL,3/32 THICK,4 BEN	402.03
CWPF3143-241	SHROUD,SHEET,STEEL,3/32 THICK,4 BEN	402.04
CWPF3143-251	SHROUD,SHEET,STEEL,3/32 THICK,4 BEN	402.05
CWPF3143-261	SHROUD,SHEET,STEEL,3/32 THICK,4 BEN	402.06
CWPF3143-271	SHROUD,SHEET,STEEL,3/32 THICK,4 BEN	402.07
CWPF3143-281	SHROUD,SHEET,STEEL,3/32 THICK,4 BEN	402.08
CWPF3143-291	SHROUD,SHEET,STEEL,3/32 THICK,4 BEN	402.09
CWPF3143-311	SHROUD,SHEET,STEEL,3/32 THICK,4 BEN	402.11
CWPF3143-321	SHROUD,SHEET,STEEL,3/32 THICK,4 BEN	402.12
CWPF3143-331	SHROUD,SHEET,STEEL,3/32 THICK,4 BEN	402.13
CWPF3143-341	SHROUD,SHEET,STEEL,3/32 THICK,4 BEN	402.14
CWPF3143-351	SHROUD,SHEET,STEEL,3/32 THICK,4 BEN	402.15
CWPF3143-361	SHROUD,SHEET,STEEL,3/32 THICK,4 BEN	402.16
CWPF3143-711	SHROUD,SHEET,STEEL,3/32 THICK,4 BEN	402.17
CWPF3144-721	SHROUD BRKT,PLATE,STEEL,1/8 THICK,1	403
CWPF3145-721	SHROUD BRKT,PLATE,STEEL,1/8 THICK,2	404
CWTAYN031-100	SCREW, BUTTON HEAD, BLK XYLAN, 5/1	405
CWWALYN031-008	WASHER, SPLIT, 5/16 ID, BL	406

CWWBKN031-007	WASHER, FLAT, TYPE A, SAE, 5/16 ID	407
CWAC1177-101	FLOOR PROTECTOR, RUBBER, 4.563 X 4.	501
CWAC1178-101	FLOOR PROTECTOR, RUBBER, 2.563 X 6.	502

500 Shoulder Press

Part Number	Description	Bubble Number
CW500SA1-211	ASSY,FRAME,MAIN,500,SKY WHITE	1.01
CW500SA1-221	ASSY,FRAME,MAIN,500,BLACK	1.02
CW500SA1-231	ASSY,FRAME,MAIN,500,RED	1.03
CW500SA1-241	ASSY,FRAME,MAIN,500,PLAT SPRKLE	1.04
CW500SA1-251	ASSY,FRAME,MAIN,500,SILVER	1.05
CW500SA1-261	ASSY,FRAME,MAIN,500,BLUE	1.06
CW500SA1-271	ASSY,FRAME,MAIN,500,CHARCOAL	1.07
CW500SA1-281	ASSY,FRAME,MAIN,500,CATH GRAY	1.08
CW500SA1-291	ASSY,FRAME,MAIN,500,SILVER VIEN	1.09
CW500SA1-311	ASSY,FRAME,MAIN,500,STONE HG	1.11
CW500SA1-321	ASSY,FRAME,MAIN,500,TITANIUM HG	1.12
CW500SA1-331	ASSY,FRAME,MAIN,500,WHITE GLOSS	1.13
CW500SA1-341	ASSY,FRAME,MAIN,500,BLACK ONYX	1.14
CW500SA1-351	ASSY,FRAME,MAIN,500,LT. BRONZE	1.15
CW500SA1-361	ASSY,FRAME,MAIN,500,SAPPHIRE BL	1.16
CW500SA2-211	ASSY,SEAT FRAME,500,SKY WHITE	2.01
CW500SA2-212	ASSY,SEAT FRAME,500,SKY WHITE	2.01
CW500SA2-221	ASSY,SEAT FRAME,500,BLACK	2.02
CW500SA2-222	ASSY,SEAT FRAME,500,BLACK	2.02
CW500SA2-231	ASSY,SEAT FRAME,500,RED	2.03
CW500SA2-241	ASSY,SEAT FRAME,500,PLATINUM SPRKL	2.04
CW500SA2-251	ASSY,SEAT FRAME,500,LIGHT BRONZE	2.05
CW500SA2-261	ASSY,SEAT FRAME,500,BLUE	2.06
CW500SA2-271	ASSY,SEAT FRAME,500,CHARCOAL	2.07
CW500SA2-281	ASSY,SEAT FRAME,500,CATHEDRAL GREY	2.08
CW500SA2-291	ASSY,SEAT FRAME,500,SILVER VIEN	2.09
CW500SA2-311	ASSY,SEAT FRAME,500,STONE HG	2.11
CW500SA2-312	ASSY,SEAT FRAME,500,STONE HG	2.11
CW500SA2-321	ASSY,SEAT FRAME,500,TITANIUM HG	2.12
CW500SA2-322	ASSY,SEAT FRAME,500,TITANIUM HG	2.12
CW500SA2-331	ASSY,SEAT FRAME,500,WHITE GLOSS	2.13
CW500SA2-341	ASSY,SEAT FRAME,500,BLACK ONYX	2.14
CW500SA2-351	ASSY,SEAT FRAME,500,LIGHT BRONZE	2.15
CW500SA2-352	ASSY,SEAT FRAME,500,LIGHT BRONZE	2.15
CW500SA2-361	ASSY,SEAT FRAME,500,SAPPHIRE BLUE	2.16
CW500SA2-362	ASSY,SEAT FRAME,500,SAPPHIRE BLUE	2.16
CW500SA3-211	ASSY,PRESS ARM,500,SKY WHITE	3.01
CW500SA3-221	ASSY,PRESS ARM,500,BLACK	3.02
CW500SA3-231	ASSY,PRESS ARM,500,RED	3.03
CW500SA3-241	ASSY,PRESS ARM,500,PLAT SPKLE	3.04
CW500SA3-251	ASSY,PRESS ARM,500,SILVER	3.05
CW500SA3-261	ASSY,PRESS ARM,500,BLUE	3.06
CW500SA3-271	ASSY,PRESS ARM,500,CHARCOAL	3.07
CW500SA3-281	ASSY,PRESS ARM,500,CATH GRY	3.08
CW500SA3-291	ASSY,PRESS ARM,500,SILVER VIEN	3.09
CW500SA3-311	ASSY,PRESS ARM,500,STONE HG	3.11
CW500SA3-321	ASSY,PRESS ARM,500,TITANIUM HG	3.12
CW500SA3-331	ASSY,PRESS ARM,500,WHITE GLOSS	3.13
CW500SA3-341	ASSY,PRESS ARM,500,BLACK ONYX	3.14

CW500SA3-351	ASSY,PRESS ARM,500,LIGHT BRONZE	3.15
CW500SA3-361	ASSY,PRESS ARM,500,SAPPHIRE BLUE	3.16
CW500SA4-721	ASSY, 500 PIVOTING COUNTERBALAN	4
CW500SA5-211	ASSY,UPPER LINK STRUT,500,SKY WHITE	5.01
CW500SA5-221	ASSY,UPPER LINK STRUT,500,BLACK	5.02
CW500SA5-231	ASSY,UPPER LINK STRUT,500,RED	5.03
CW500SA5-241	ASSY,UPPER LINK STRUT,500,PLATINUM	5.04
CW500SA5-251	ASSY,UPPER LINK STRUT,500,SILVER	5.05
CW500SA5-261	ASSY,UPPER LINK STRUT,500,BLUE	5.06
CW500SA5-271	ASSY,UPPER LINK STRUT,500,CHARCOAL	5.07
CW500SA5-281	ASSY,UPPER LINK STRUT,500,CATHEDRAL	5.08
CW500SA5-291	ASSY,UPPER LINK STRUT,500,SILVER VI	5.09
CW500SA5-311	ASSY,UPPER LINK STRUT,500,STONG HG	5.11
CW500SA5-321	ASSY,UPPER LINK STRUT,500,TITANIUM	5.12
CW500SA5-331	ASSY,UPPER LINK STRUT,500,WHITE GLO	5.13
CW500SA5-341	ASSY,UPPER LINK STRUT,500,BLACK ONY	5.14
CW500SA5-351	ASSY,UPPER LINK STRUT,500,LIGHT BRO	5.15
CW500SA5-361	ASSY,UPPER LINK STRUT,500,SAPPHIRE	5.16
CW500SA6-211	ASSY,LOWER LINK STRUT,500,SKY WHITE	6.01
CW500SA6-221	ASSY,LOWER LINK STRUT,500,BLACK	6.02
CW500SA6-231	ASSY,LOWER LINK STRUT,500,RED	6.03
CW500SA6-241	ASSY,LOWER LINK STRUT,500,PLATINUM	6.04
CW500SA6-251	ASSY,LOWER LINK STRUT,500,SILVER	6.05
CW500SA6-261	ASSY,LOWER LINK STRUT,500,BLUE	6.06
CW500SA6-271	ASSY,LOWER LINK STRUT,500,CHARCOAL	6.07
CW500SA6-281	ASSY,LOWER LINK STRUT,500,CATHEDRAL	6.08
CW500SA6-291	ASSY,LOWER LINK STRUT,500,SILVER VI	6.09
CW500SA6-311	ASSY,LOWER LINK STRUT,500,STONE HG	6.11
CW500SA6-321	ASSY,LOWER LINK STRUT,500,TITANIUM	6.12
CW500SA6-331	ASSY,LOWER LINK STRUT,500,WHITE GLO	6.13
CW500SA6-341	ASSY,LOWER LINK STRUT,500,BLACK ONY	6.14
CW500SA6-351	ASSY,LOWER LINK STRUT,500,LIGHT BRO	6.15
CW500SA6-361	ASSY,LOWER LINK STRUT,500,SAPPHIRE	6.16
CWAC1009-101	PULLEY, 4 1/2 DIA. X 1/2 ID	10
CWAC1010-101	PULLEY, 6 DIA X 1/2 ID	11
CW12406-101	PILLOW BLOCK, BEARING, 2 BOLT	12
CW12404-101	CAP, GUIDE ROD,DIA 3/4, BLK	13
CW30165-751	ASSY, POP PIN, 0.450 DIA HANDLE, B	14
CW32460-321	ASSY, RATCHETING LEVER, TITANIUM	14
CW11311-102	ENDCAP, REC TUBE, 2X4, BLK PLASTIC	15
CW11311-103	ENDCAP, REC TUBE, 2X2, BLK PLASTIC	16
CW12402-101	BUMPER, WEIGHT STACK, BLK RUBBER	17
CWGR2621-000	GRIP,RUBBER, 1" DIA, 21"	22
CWAC1228-901	SPACER, ALU,.328 ID X .625 OD X .25	23
CWAC1236-101	GUIDE INSERT, PLASTIC WITHOUT HOLE,	25
CWAC1236-102	GUIDE INSERT, PLASTIC WITH HOLE, BL	26
CWAC218-901	HANDLE END CAP W/SET SCREWS, DIA 1"	27
CWPF1212-711	GUIDE ROD, 3/4 X 42 5/8 (#4), CHM	29
CW30288-711	ASSY,SEAT ADJUST,20 DEGREE, 8 HOLE,	30
CW32212-711	ASSEMBLY, SEATPAD ADJUSTMENT, 8 HO	30
CW30014-105	CUT PIECE, CREPE, 7/16 X 2 X 4	31

CW30014-113	CUT PIECE, CREPE, 7/16 X 3 3/4 X 3	32
CWCLGP112-125	ASSY, CABLE, 500	33
CWPD1102J-101	PAD,FLAT,10X36,4HOLES,W/BP,BLACK,W/	34.01
CWPD1102J-102	PAD,FLAT,10X36,4HOLES,W/BP,RYL BL,W	34.02
CWPD1102J-103	PAD,FLAT,10X36,4HOLES,W/BP,DVE GRY,	34.03
CWPD1102J-104	PAD,FLAT,10X36,4HOLES,W/BP,CROCUS,W	34.04
CWPD1102J-105	PAD,FLAT,10X36,4HOLES,W/BP,GROTTO,W	34.05
CWPD1102J-106	PAD,FLAT,10X36,4HOLES,W/BP,GRAPHITE	34.06
CWPD1102J-107	PAD,FLAT,10X36,4HOLES,W/BP,RED,W/SL	34.07
CWPD1102J-108	PAD,FLAT,10X36,4HOLES,W/BP,CHN GRN,	34.08
CWPD1102J-109	PAD,FLAT,10X36,4HOLES,W/BP,TURQSE,W	34.09
CWPD1102J-110	PAD,FLAT,10X36,4HOLES,W/BP,RASP,W/S	34.1
CWPD1102J-111	PAD,FLAT,10X36,4HOLES,W/BP,PLUM,W/S	34.11
CWPD1102J-112	PAD,FLAT,10X36,4HOLES,W/BP,REGIMENT	34.12
CWPD1102J-113	PAD,FLAT,10X36,4HOLES,W/BP,SPC BLUE	34.13
CWPD1102J-115	PAD,FLAT,10X36,4HOLES,W/BP,BLK LTHR	34.15
CWPD1102J-116	PAD,FLAT,10X36,4HOLES,W/BP,NVBL LTH	34.16
CWPD1102J-117	PAD,FLAT,10X36,4HOLES,W/BP,PUTTY,W/	34.17
CWPD1102J-118	PAD,FLAT,10X36,4HOLES,W/BP,IMPRL BL	34.18
CWPD1102J-119	PAD,FLAT,10X36,4HOLES,W/BP,YEW GRN,	34.19
CWPD1102J-120	PAD,FLAT,10X36,4HOLES,W/BP,DSTY JDE	34.2
CWPD1102J-121	PAD,FLAT,10X36,4HLS,W/BP,TRRA CTTA,	34.21
CWPD1102J-122	PAD,FLAT,10X36,4HOLES,W/BP,PAPRIKA,	34.22
CWPD1102J-123	PAD,FLAT,10X36,4HLS,W/BP,ASH LTHR,W	34.23
CWPD1102J-124	PAD,FLAT,10X36,4HL,W/BP,CERULN LTH,	34.24
CWPD1102J-125	PAD,FLAT,10X36,4HL,W/BP,CHARCL LTH,	34.25
CWPD1102J-126	PAD,FLAT,10X36,4HLS,W/BP,HUNTER LTH	34.26
CWPD1102J-127	PAD,FLAT,10X36,4HLS,W/BP,MOSS LTH,W	34.27
CWPD1102J-128	PAD,FLAT,10X36,4HLS,W/BP,SPICE LTH,	34.28
CWPD1102J-129	PAD,FLAT,10X36,4HLS,W/BP,TOMATO LTH	34.29
CWPD1207B-101	PAD,5X9X14.5,4HOLES,W/BP,BLACK	35.01
CWPD1207B-102	PAD,5X9X14.5,4HOLES,W/BP,RYL BL	35.02
CWPD1207B-103	PAD,5X9X14.5,4HOLES,W/BP,DVE GRY	35.03
CWPD1207B-104	PAD,5X9X14.5,4HOLES,W/BP,CROCUS	35.04
CWPD1207B-105	PAD,5X9X14.5,4HOLES,W/BP,GROTTO	35.05
CWPD1207B-106	PAD,5X9X14.5,4HOLES,W/BP,GRAPHITE	35.06
CWPD1207B-107	PAD,5X9X14.5,4HOLES,W/BP,RED	35.07
CWPD1207B-108	PAD,5X9X14.5,4HOLES,W/BP,CHN GRN	35.08
CWPD1207B-109	PAD,5X9X14.5,4HOLES,W/BP,TURQSE	35.09
CWPD1207B-110	PAD,5X9X14.5,4HOLES,W/BP,RASP	35.1
CWPD1207B-111	PAD,5X9X14.5,4HOLES,W/BP,PLUM	35.11
CWPD1207B-112	PAD,5X9X14.5,4HOLES,W/BP,REGIMENT	35.12
CWPD1207B-113	PAD,5X9X14.5,4HOLES,W/BP,SPC BLUE	35.13
CWPD1207B-115	PAD,5X9X14.5,4HOLES,W/BP,BLK LTHR	35.15
CWPD1207B-116	PAD,5X9X14.5,4HOLES,W/BP,NVBL LTH	35.16
CWPD1207B-117	PAD,5X9X14.5,4HOLES,W/BP,PUTTY	35.17
CWPD1207B-118	PAD,5X9X14.5,4HOLES,W/BP,IMPRL BL	35.18
CWPD1207B-119	PAD,5X9X14.5,4HOLES,W/BP,YEW GRN	35.19
CWPD1207B-120	PAD,5X9X14.5,4HOLES,W/BP,DSTY JD	35.2
CWPD1207B-121	PAD,5X9X14.5,4HOLES,W/BP,TER COT	35.21
CWPD1207B-122	PAD,5X9X14.5,4HOLES,W/BP,PAPRIKA	35.22

CWPD1207B-123	PAD,5X9X14.5,4HLS,W/BP,ASH LTHR	35.23
CWPD1207B-124	PAD,5X9X14.5,4HLS,W/BP,CERULAN LTHR	35.24
CWPD1207B-125	PAD,5X9X14.5,4HLS,W/BP,CHARCOAL LTH	35.25
CWPD1207B-126	PAD,5X9X14.5,4HLS,W/BP,HUNTER LTHR	35.26
CWPD1207B-127	PAD,5X9X14.5,4HLS,W/BP,MOSS LTHR	35.27
CWPD1207B-128	PAD,5X9X14.5,4HLS,W/BP,SPICE LTHR	35.28
CWPD1207B-129	PAD,5X9X14.5,4HLS,W/BP,TOMATO LTH	35.29
CWPF1016-731	BAR,,FLAT CR/HR, 3/8 X 2 X 8 1/4, 3	36
CWPF1136-731	LINK ARM, 11", W/ THRD ENDS, 712, B	37
CWPF3186-741	BAR,STEEL, RND, DIA. 1" X (1 1/2),	38
CWPF3212-731	BAR,STEEL, RND, DIA. 0.995" X (5),	39
CW30103-200	WEIGHT STACK,200 LBS,MTP-S,19 X 10	40
CWHCYN050-100	SCREW,HEX HEAD,BLK XYLAN,1/2-13 X 1	41
CWHCYN050-200	SCREW, HEX HEAD, BLK XYLAN, 1/2-13	42
CWHCYN050-400	SCREW, HEX HEAD, BLK XYLAN, 1/2-13	43
CWHCYN050-500	SCREW, HEX HEAD, BLK XYLAN, 1/2-13	44
CWRANN038-063	BOLT, SHOULDER, 3/8-16 X 1/2 X 5/8	45
CWKDYN050-059	LOCKNUT, NYLON INSERT, FULL, UNC, 1	46
CWKADLN050-081	NUT, ACORN, 1/2-13	47
CWKBEYN050-031	NUT, HEX, THIN, LEFT HAND THREAD,	48
CWKRYN050-031	NUT, HEX THIN, UNF, 1/2-20, BLK XYL	49
CW12537-109	NUT,INSERT,THIN-NUT,LARGE FLANGE	50
CWCLFA1063-741	ROD END, FEMALE, STEEL, ZINC, CAD,	51
CWCLFA1064-741	ROD END, FEMALE, STEEL, ZINC, CAD,	52
CWTAYN031-100	SCREW, BUTTON HEAD, BLK XYLAN, 5/1	53
CWTAYN031-150	SCREW, BUTTON HEAD, BLK XYLAN,5/16	54
CWTAYN031-300	SCREW, BUTTON HEAD, BLK XYLAN,5/16	55
CWEANN038-038	SCREW,SET,SCKT,CUP POINT,3/8-16X3/8	56
CWBFNN050-250	STUD, 1/2-13 X 2 1/2	57
CWWBKN031-007	WASHER, FLAT, TYPE A, SAE, 5/16 ID	58
CWWBKN038-007	WASHER, FLAT, TYPE A, SAE, 3/8 ID	59
CWWBKN050-010	WASHER, FLAT, TYPE A, SAE, 1/2 ID X	60
CWWALYN031-008	WASHER, SPLIT, 5/16 ID, BL	61
CWWALYN038-009	WASHER, SPLIT, 3/8 ID, BLK XYLAN	62
CWWALYN050-013	WASHER, SPLIT, 1/2 ID, BLK XYLAN	63
CWCAYN038-125	SCREW, SOCKET HEAD, BLK X	64
CWCAYN038-275	SCREW, SOCKET HEAD, BLK XYLAN, 3/	65
CW30010-101	LABEL,WARNING STRENGTH	66
CW30145-101	ASSY, LABEL,INSTRUCTION,500	67
CW31756-101	LABEL, PRECOR USA ICARIAN LINE	68
CWPF4002-711	WELDMENT, SEAT ADJUST, 20 DEGREE, 8	70
CWAC220-901	HANDLE END CAP W/SET SCREWS, DIA 3/	71
CW12634-101	SPRING, TORSION 90 DEG X 0.484 X 0.	72
CWGR2505-000	GRIP,RUBBER,3/4" DIA, 5"	72
CW31770-742	LATCH PIVOTING PIN, CLR ZN	73
CW31784-731	STOP PLUG, BLK ZN	73
CWAMNN028-003	RING, RETAINING, 2-TURN, SPIRAL, SS	74
CW12633-101	ENDCAP, REC TUBE, LDP, 1 1/2 X 3 1	75
CW10510-721	ASSY, PLATE, WEIGHT, 10 LBS, WRKL B	201
CW10520-721	ASSY, PLATE, WEIGHT, 20 LBS, WRKL B	202
CWAC1133-101	BUSHING, WEIGHT PLATE, LDPE PLASTIC	203

CW30172-751	ASSY, 4.00 IN WEIGHT STACK PIN AND	227
CW30173-751	ASSY, 6.00 IN WEIGHT STACK PIN AND	228
CWLDNN038-200	PIN, ROLL, DIA 3/8 X 2	250
CW30184-901	ASSY,BARREL,TOP PLATE,ALUMINUM	251
CW10550-722	PLATE, WEIGHT, MED TOP (MTP-S), 10	283
CW30132-711	SELECTOR STEM, 20 PLATE,0 .875 DIA,	308
CW30011-101	LABEL,WARNING WEIGHT STACK	311
CW12401-106	LABEL, WEIGHT PLATE, 20 LBS/ 8 KG	319
CW12401-110	LABEL, WEIGHT PLATE, 30 LBS/ 13.6 K	323
CW12401-114	LABEL, WEIGHT PLATE, 40 LBS/ 18.2 K	327
CW12401-118	LABEL, WEIGHT PLATE, 50 LBS/ 22.7 K	331
CW12401-120	LABEL, WEIGHT PLATE, 60 LBS/ 27.3 K	333
CW12401-122	LABEL, WEIGHT PLATE, 70 LBS/ 31.8 K	335
CW12401-124	LABEL, WEIGHT PLATE, 80 LBS/ 36.4 K	337
CW12401-126	LABEL, WEIGHT PLATE, 90 LBS/ 40.9 K	339
CW12401-128	LABEL, WEIGHT PLATE, 100 LBS/ 45.5	341
CW12401-129	LABEL, WEIGHT PLATE, 110 LBS/ 50 KG	342
CW12401-130	LABEL, WEIGHT PLATE, 120 LBS/ 54.6	343
CW12401-131	LABEL, WEIGHT PLATE, 130 LBS/ 59.1	344
CW12401-132	LABEL, WEIGHT PLATE, 140 LBS/ 63.6	345
CW12401-133	LABEL, WEIGHT PLATE, 150 LBS/ 68.2	346
CW12401-134	LABEL, WEIGHT PLATE, 160 LBS/ 72.7	347
CW12401-135	LABEL, WEIGHT PLATE, 170 LBS/ 77.3	348
CW12401-136	LABEL, WEIGHT PLATE, 180 LBS/ 81.8	349
CW12401-137	LABEL, WEIGHT PLATE, 190 LBS/ 86.4	350
CW12401-138	LABEL, WEIGHT PLATE, 200 LBS/ 90.9	351
CW12401-139	LABEL, WEIGHT PLATE, 210 LBS/ 95.5	352
CW12401-141	LABEL, WEIGHT PLATE, 230 LBS/ 104.6	354
CW12401-143	LABEL, WEIGHT PLATE, 250 LBS/ 113.6	356
CW12537-109	NUT,INSERT,THIN-NUT,LARGE FLANGE	400
CW30126-101	LABEL,VINYL, PRECOR, 3.25 X 18.0	401
CWPF3143-211	SHROUD,SHEET,STEEL,3/32 THICK,4 BEN	402.01
CWPF3143-221	SHROUD,SHEET,STEEL,3/32 THICK,4 BEN	402.02
CWPF3143-231	SHROUD,SHEET,STEEL,3/32 THICK,4 BEN	402.03
CWPF3143-241	SHROUD,SHEET,STEEL,3/32 THICK,4 BEN	402.04
CWPF3143-251	SHROUD,SHEET,STEEL,3/32 THICK,4 BEN	402.05
CWPF3143-261	SHROUD,SHEET,STEEL,3/32 THICK,4 BEN	402.06
CWPF3143-271	SHROUD,SHEET,STEEL,3/32 THICK,4 BEN	402.07
CWPF3143-281	SHROUD,SHEET,STEEL,3/32 THICK,4 BEN	402.08
CWPF3143-291	SHROUD,SHEET,STEEL,3/32 THICK,4 BEN	402.09
CWPF3143-311	SHROUD,SHEET,STEEL,3/32 THICK,4 BEN	402.11
CWPF3143-321	SHROUD,SHEET,STEEL,3/32 THICK,4 BEN	402.12
CWPF3143-331	SHROUD,SHEET,STEEL,3/32 THICK,4 BEN	402.13
CWPF3143-341	SHROUD,SHEET,STEEL,3/32 THICK,4 BEN	402.14
CWPF3143-351	SHROUD,SHEET,STEEL,3/32 THICK,4 BEN	402.15
CWPF3143-361	SHROUD,SHEET,STEEL,3/32 THICK,4 BEN	402.16
CWPF3143-711	SHROUD,SHEET,STEEL,3/32 THICK,4 BEN	402.17
CWPF3144-721	SHROUD BRKT,PLATE,STEEL,1/8 THICK,1	403
CWPF3145-721	SHROUD BRKT,PLATE,STEEL,1/8 THICK,2	404
CWTAYN031-100	SCREW, BUTTON HEAD, BLK XYLAN, 5/1	405
CWWALYN031-008	WASHER, SPLIT, 5/16 ID, BL	406

CWWBKN031-007	WASHER, FLAT, TYPE A, SAE, 5/16 ID	407
CWAC1177-101	FLOOR PROTECTOR, RUBBER, 4.563 X 4.	501
CWAC1178-101	FLOOR PROTECTOR, RUBBER, 2.563 X 6.	502